



## High Temperature Pressure Sensor

### MODEL ASI 20HT

#### FEATURES:

- One piece design
- No welded, No oil-filling, No O-ring
- Excellent accuracy
- Excellent long-term stability

#### APPLICATIONS:

- Semiconductor Manufacturing
- Power Generation
- High Pressure Steam
- Chemical Reactor
- Oil & Gas
- Down Holes

#### PRODUCT OVERVIEW:

ASI 20HT is designed to measure pressure measurements under high environment and media temperatures. The Hastelloy C276 wetted parts offer excellent media compatibility with wide range of liquids and gases. Inorganic bonding of the sensing element offers high stability over along periods of time.



Model ASI 20HT  
High Temperature Pressure Sensor

# MODEL ASI 20HT

## DIMENSIONAL DRAWING

All dimensions are in inches (mm)

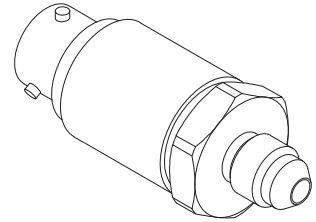
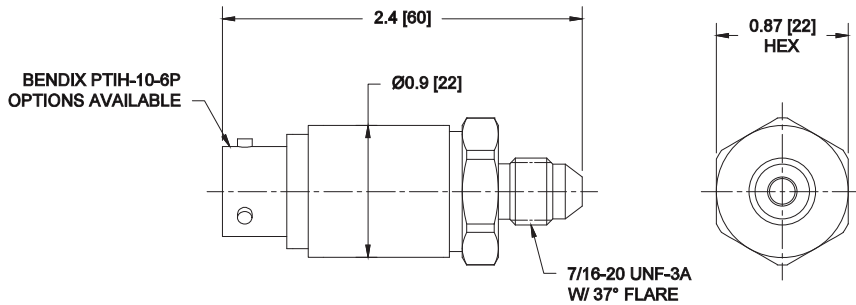

WIRING CONFIGURATION

PIN(A/#)	mV/V
A/1	+EXCITATION(R)
B/2	+OUTPUT(G)
C/3	-OUTPUT(W)
D/4	-EXCITATION(B)
E/5	NO CONNECT
F/6	NO CONNECT

\* PARENTHESES() REPRESENT COLORS FOR CABLE OPTION. (R) = RED, (B) = BLACK, (G) = GREEN, (W) = WHITE  
\*\* CUSTOM PINOUTS AVAILABLE. SHUNTS AND TEMPERATURE PINS MAY BE USED WITH ADDITIONAL COLORS

## REFERENCE SPECIFICATIONS

### ELECTRICAL

- Output Signal: 5mV/V (Less than 200PSI), 10mV/V
- Connection: Bendix 6-Pin Connector (PTIH-10-6P)
- Excitation: 5VDC, typ., 10VDC Maximum
- Current Consumption: < 5mA
- Pressure Cycles: > 100 Million at full pressure
- Isolation Voltage: 500VDC

### ACCURACY (HYSTERESIS, NON-LINEARITY & REPEATABILITY @ +70°F)

- Static Accuracy (RSS): < ± 0.25% BFSL, typ. (Linearity calculated using BFSL)
- Zero/span balance: < ±2% of FS

### THERMAL SPECIFICATION

- Compensated Range: 20 to 100°C
- TC Zero: < ±0.02% of FS / °C typ.
- TC Span: < ±0.02% of FS / °C typ.
- Operating Ambient: -40 to 200°C
- Media: -55 to 200°C

### MECHANICAL

- Process Port: 1/4" VCR, 7/16-20UNF-3A Male w/37° Flare
- Proof Pressure: 2X Rated pressure
- Burst Pressure: 5X or 20,000PSI (whichever is less)

### PRESSURE RANGES

- 0-100 TO 3000PSI (1/4" VCR)
- 0-100 TO 10000PSI (7/16-20UNF-3A Male w/37° Flare)

### MATERIALS OF CONSTRUCTION

- Wetted Parts: Hastelloy C276, One piece structure

\*Some options may invalidate Mil-specifications.  
Please consult factory for your specific needs.

**Standard configurations shown.**

All specifications are for reference purposes only. In the interests of continuous product improvement, all specifications are subject to change without notice. Please contact ASI 20HT for assistance with your application.